

The name means “Rising of the Sun” and was derived from the breathtaking sunrises you can experience daily from the luxurious Oceanfront residences. Each of the condominiums feature expansive wraparound balconies where you can dine outside while listening to the waves and feeling the gentle ocean breeze. Floor-to-Ceiling windows in your Breakfast Nook overlooking the Ocean or your Dining Room Facing the Intracoastal allow you to dine inside while watching the dolphins play outside. Imagine soaking in your jetted tub in your luxurious master bath suite after a day in the beautiful Florida sunshine enjoying the various recreational activities that the Daytona Beach area has to offer. Salida del Sol is located in Daytona Beach Shores. Salida del Sol is south of the last mainland access and is very convenient to shopping, banks, restaurants, and interstate access.

#### Floor Plan A

**Ocean View and Direct River View Residence, Either NW or SW Corner**

**1815 square feet living**

**+449 square feet balcony**

**2264 Total Square Feet**

**Floor-to-Ceiling Window Overlooking the Intracoastal in your Dining Room**

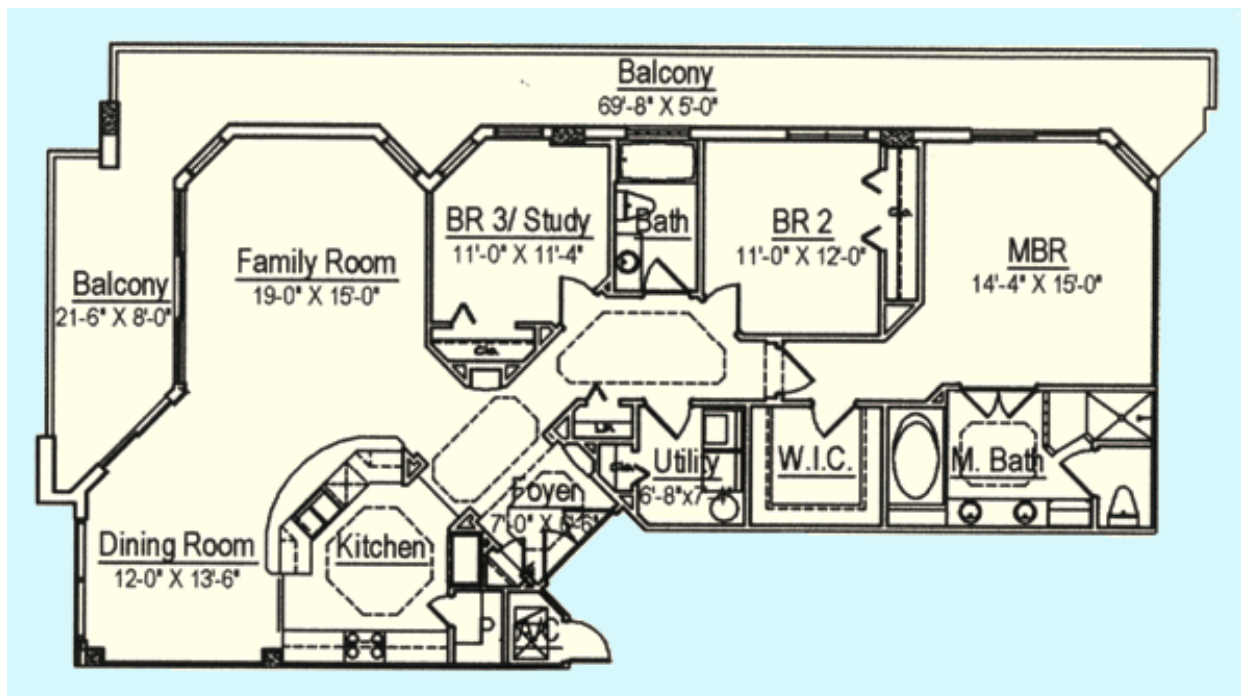

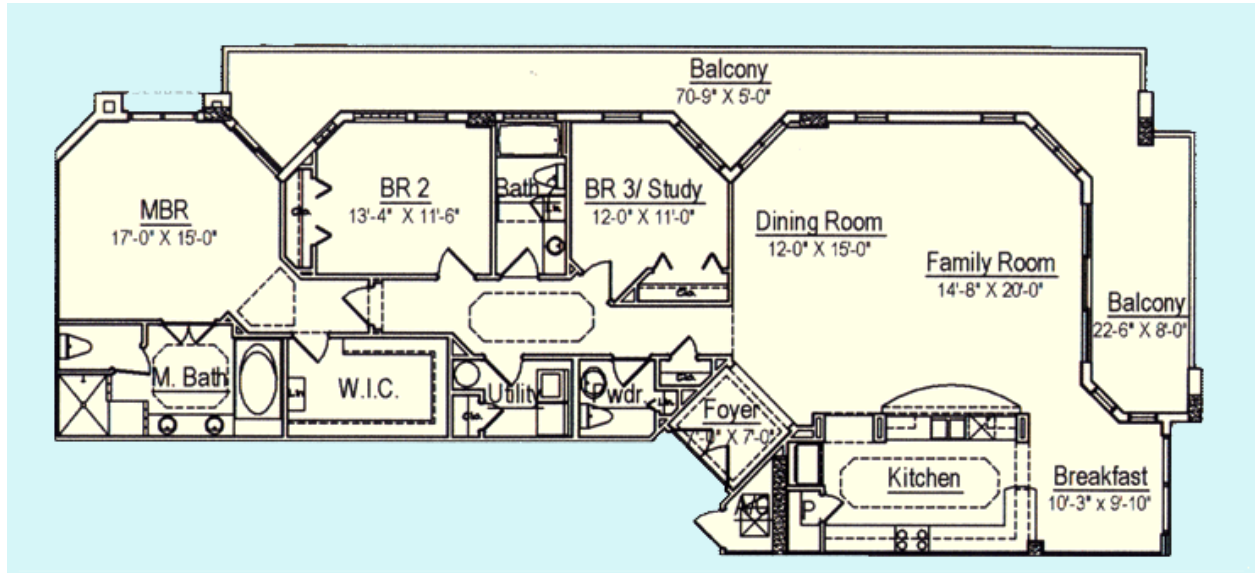
**Ocean Front Residence****Direct Oceanfront Residence , Either North East or South East Corner****2245 square feet living****+523 square feet balcony****2768 Total Square Feet****Floor-to-Ceiling Window Overlooking the Ocean in your Breakfast Nook**

**COMMUNITY FEATURES**

- Only 43 private residences with Wrap Around Balconies
- Located on 150 ' of Gorgeous Oceanfront
- Residences are Direct Ocean Front or Intercoastal View
- Large Heated Pool with Spa
- Social Room with Kitchen
- Fitness Center with Latest Equipment
- Fully Outfitted Game Room/Media Center
- Secured Parking Garage
- Secured Building Entrances with Linkup to Each Residence
- Concrete and Block Construction Meeting All Current State of Florida Wind Codes
- Trash Chutes on Each Floor
- Storage Bin for Each Residence
- Private Gated Access to Beach
- Close proximity to shopping such as Publix, Walgreen and Restaurants

**RESIDENCE FEATURES**

- 9'4" Ceiling Height in Residences
- Wrap Around Balconies
- Ceramic Tile in Kitchen, Breakfast Nook, Foyer and Bathrooms
- GE Profile Appliances to Include Dishwasher, Range, Double Door 23 Cubic Foot Refrigerator and Microwave Oven with Exhaust Fan
- Granite Countertops in Kitchen and Bathrooms
- Spa Jetted Tub and Ceramic Tile Shower in Master Bathroom Suite
- CAT-5 Wiring in Each Residence for Telephone and Internet
- Individually Controlled Heating and Air Conditioning
- Automatic Fire Sprinkler System
- Ceiling Fans in Bedrooms and Living Room
- Pre-Wired Cable Television